

## Nyloc Insert Nut

**Thread Type:** Metric - Coarse

**Thread Direction:** Right Hand

**Material:** Carbon Steel

**Class Grade:** High Tensile Class 8

**Finish:** Zinc Yellow

**Corrosion Protection Level:** Moderate

**Standard:** DIN 985

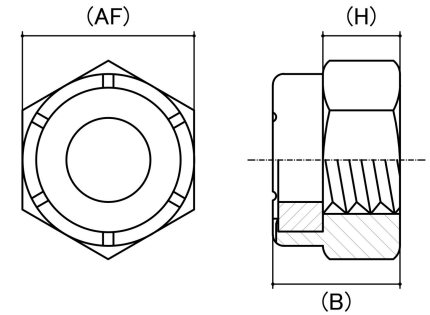

*CAD drawings shown for graphic representation only.\**

Size	Thread Pitch (mm)	Thread Type	Overall Nut Height (B) (mm)		Hex Height (H) (mm)	Across Flats (AF) (mm)		Spanner Size (AF) (mm)	sku (qfind)
			Min	Max	Nom	Min	Max		
M5	0.80	Coarse	4.70	5.00	3.20	7.78	8.00	8	41N5ZY
M6	1.00	Coarse	5.70	6.00	4.00	9.78	10.00	10	41N6ZY
M8	1.25	Coarse	7.64	8.00	5.50	12.73	13.00	13	41N8ZY
M10	1.50	Coarse	9.64	10.00	6.50	16.73	17.00	17	41N10ZY
M12	1.75	Coarse	11.57	12.00	8.00	18.67	19.00	19	41N12ZY
M14	2.00	Coarse	13.30	14.00	9.50	21.67	22.00	22	41N14ZY
M16	2.00	Coarse	15.30	16.00	10.50	23.67	24.00	24	41N16ZY
M18	2.50	Coarse	17.66	18.50	13.00	26.16	27.00	27	41N18ZY
M20	2.50	Coarse	18.67	20.00	14.00	29.16	30.00	30	41N20ZY

**Disclaimer:**

Dimensional data and technical information was obtained from publicly available sources and not acquired through standard agencies. It has been completed and compiled for reference purposes only; where discrepancies are found they are subject to change without notice. Bolt & Nut Australia makes no warranties or representations regarding the accuracy and validity of the compiled information and data. Contact the relevant standard authorities for accurate and detailed information.

\* CAD drawings may not reflect diameter, thread length or overall length.

© Bolt & Nut Australia Pty Ltd. All rights reserved.

Version: 18 Mar 2024